



BROCHURE  
**SHIPBUILDING  
STEEL**





## CONTENT

1. About Stavian Industrial Metal
2. Supply Capability
3. Shipbuilding Steel Portfolio
4. Product Details
5. Quality Assurance
6. Contact information

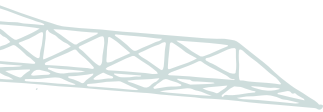



## 1. ABOUT STAVIAN INDUSTRIAL METAL



## Stavian Industrial Metal – A member of Stavian Group

Stavian Industrial Metal Joint Stock Company (abbreviated as “Stavian Industrial Metal”) is proud to be a member of Stavian Group – a large-scale multinational industrial, technology, and trading conglomerate with numerous outstanding achievements:



## Stavian Group – A multi-national industrial company

---

Founded in  
**2009**

---

Revenue  
**~ USD 3 billion (2024)**

---

Customer network  
**> 20,000 local & international customers & partners**

---

Market presence  
**> 100 countries & territories**

---

Global facilities  
**30+ international offices**  
**40+ worldwide logistics hubs**

---

**10+ manufacturing factories**



## Vision

By 2028, to become one of Southeast Asia's Top 10 largest companies in the field of industrial metals processing, investment, and trading.

## Mission

Creating utmost values for customers, shareholders, personnel, the community and natural environment through sustainable business and operational model.

## Business Scope

Stavian Industrial Metal distributes a diverse portfolio of industrial metal products with clear origins and stable supply availability, covering four main product groups:

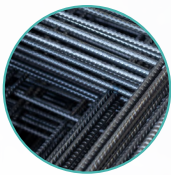

1. Steel



2. Aluminum

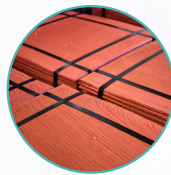

3. Copper



4. Zinc



## 2. SUPPLY CAPABILITY





## Supply capability

Inheriting Stavian Group’s global ecosystem along with an extensive domestic network of offices, warehouses, and operations, Stavian Industrial Metal possesses comprehensive supply capabilities for metal materials serving the marine and shipbuilding industries. We effectively meet diverse demands ranging from newbuilding, repair, and conversion to major overhaul of vessels in both domestic and international markets.

Leveraging a vast network of partners and customers across more than 100 countries and territories, Stavian Industrial Metal ensures an abundant, stable, and flexible supply. We are fully prepared to handle large-scale orders with urgent schedules and stringent technical specifications for shipbuilding projects, marine structures, and supporting industry supply chains. Our products are supplied in strict compliance with both domestic and international quality standards, ensuring consistency, safety, and operational efficiency for every project.

These capabilities are bolstered by a professional, efficient, and end-to-end logistics system, including transportation, warehousing, coordination, and multimodal forwarding. This infrastructure optimizes costs, shortens lead times,



and guarantees progress for marine projects that demand high time-sensitivity and supply chain continuity. Stavian Industrial Metal's logistics network is currently reinforced by:

---

Global Agents

**200+**

---

---

Domestic Branches

**06**

---

---

Nationwide Warehouses

**26+**

---

---

Trucks & Container Trailers

**2,500+**

---

---

Trips per month

**10,000+**



### **3. SHIPBUILDING STEEL PRODUCT RANGE**



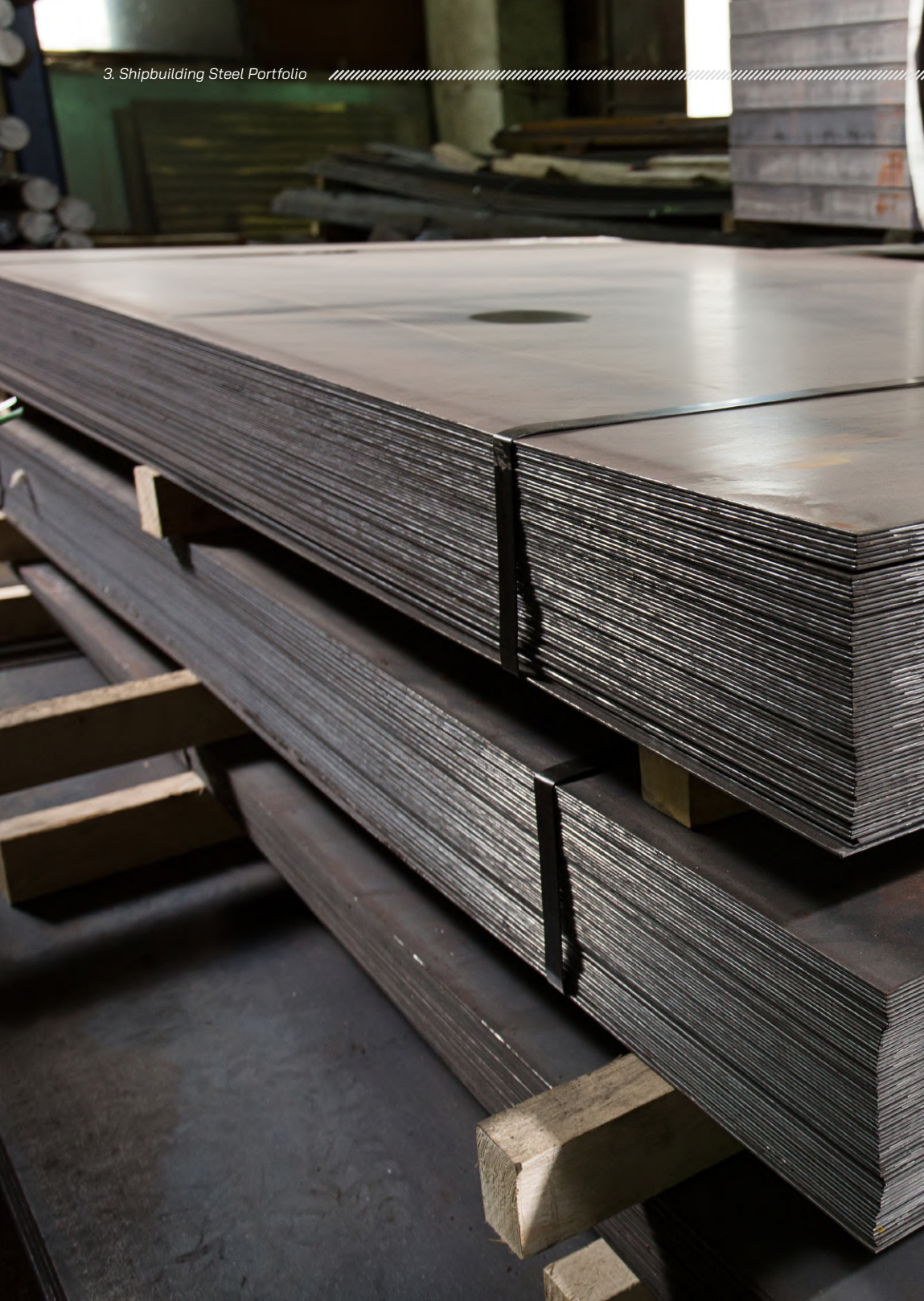
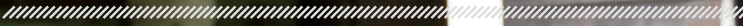

**3.1. Shipbuilding Steel Plates**

**3.2. Shipbuilding Sections**

**3.2.1. Bulb Flats**

**3.2.2. Unequal-leg Angles steel**

**3.2.3. Equal Angles steel**



## 4. PRODUCT DETAILS



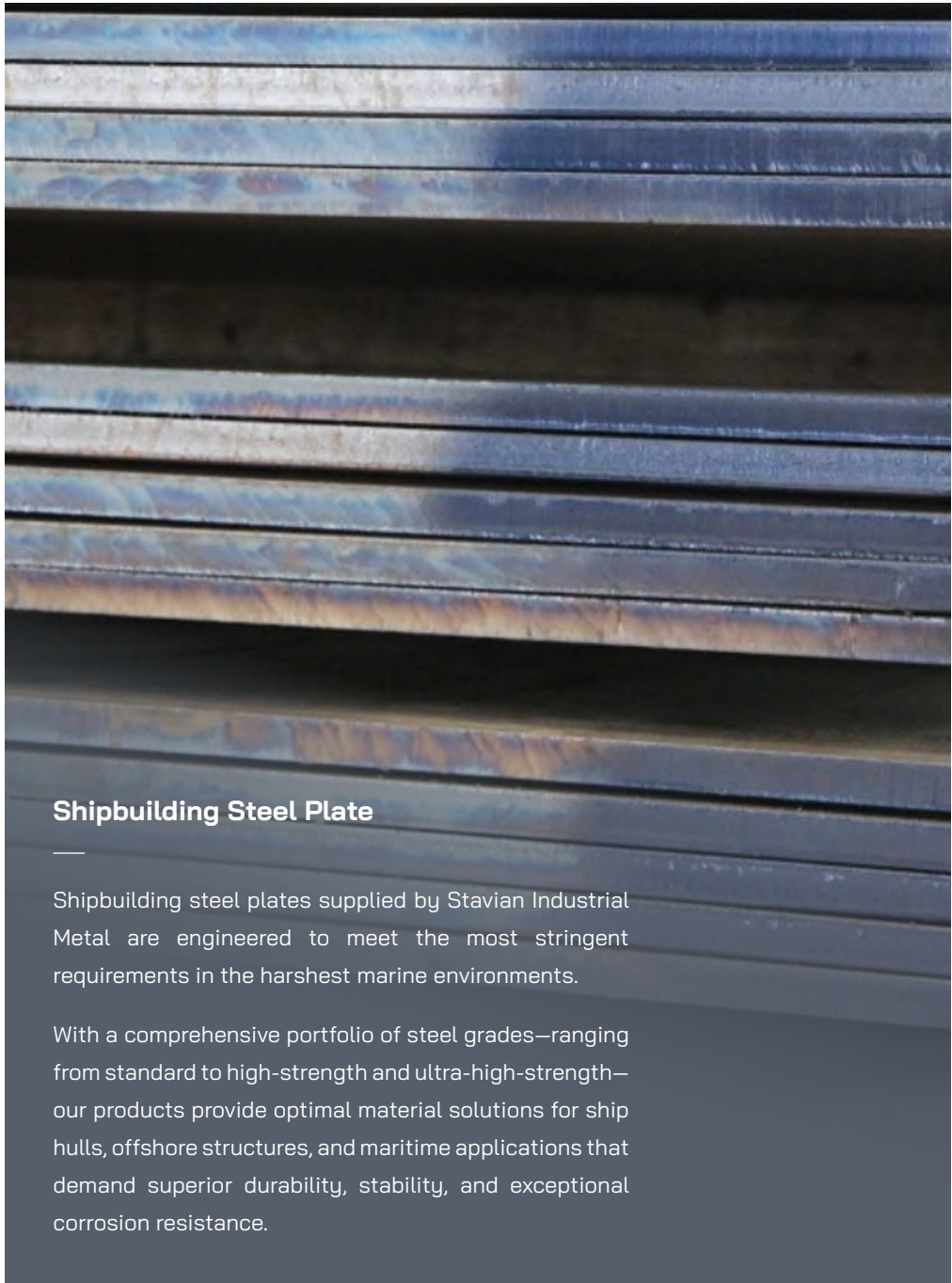

## Shipbuilding Steel Plate

---

Shipbuilding steel plates supplied by Stavian Industrial Metal are engineered to meet the most stringent requirements in the harshest marine environments.

With a comprehensive portfolio of steel grades—ranging from standard to high-strength and ultra-high-strength—our products provide optimal material solutions for ship hulls, offshore structures, and maritime applications that demand superior durability, stability, and exceptional corrosion resistance.

| CATEGORY                    | DETAILS  |
|-----------------------------|--|
| <b>Origins</b>              | Europe, Asia, America, Middle East, Africa   |
| <b>Applications</b>         | Hulls & Decks: Utilizing wide/heavy plates to optimize weight-to-strength ratios and structural integrity.   |
|                             | Bulkheads & Cargo Holds: Enhanced corrosion resistance and impact toughness to withstand bulk cargo handling.  |
|                             | Rigs & Offshore Structures: Substructures and jackets requiring AH/DH/EH high-strength steel to endure extreme wind and wave loads.  |
| <b>Technical Properties</b> | TMCP (Thermo-Mechanical Control Process): Delivers high-strength steel with excellent weldability. This technology eliminates the need for pre-heating, significantly reducing fabrication time and costs. |
|                             | Low-Temperature Toughness: Grade E and F series offer superior impact resistance at cryogenic temperatures (from -40°C to -60°C), ideal for ice-going vessels or LNG carriers.                             |
| <b>Standards</b>            | Z-Direction Testing (Z25/Z35): Guarantees high lamellar tearing resistance, protecting critical weld joints against extreme mechanical stress in the through-thickness direction.                          |
|                             | CCS, ABS, NK, BV, LR, RINA, DNV, KR, RS  |

## PRODUCT SPECIFICATIONS

### General Specifications for Shipbuilding Steel Plates

| Characteristics    | Technical Specifications | Customer Benefits  |
|--------------------|--------------------------|--|
| <b>Steel Grade</b> | A, B, D, E & AH32 – FH40 | Suitable for a wide range of vessels, from small crafts to ultra-large carriers.             |
| <b>Thickness</b>   | 4.75mm – 100mm           | Versatile application for both deck plating and hull bottoms of high-tonnage vessels.        |
| <b>Width</b>       | Up to 4800mm             | Minimizes weld seams, significantly enhancing structural integrity and reducing labor costs. |
| <b>Length</b>      | Up to 25000mm            | Optimizes the fabrication process for large-scale block assembly.                            |

### Specifications: Steel Plates Cut-to-Length from Coil

| Grade                           | Size Range   | Delivery Condition | Remarks   |
|---------------------------------|--|--------------------|---|
| A, B, D, AH32, AH36, DH32, DH36 | 3.0mm – 25mm (T) x 900mm – 2050mm (W) x 2000mm – 16000mm (L) | AR, CR, Normalized | <b>Surface Treatment:</b> Shot Blasting & Shop Primer can be provided upon request. |

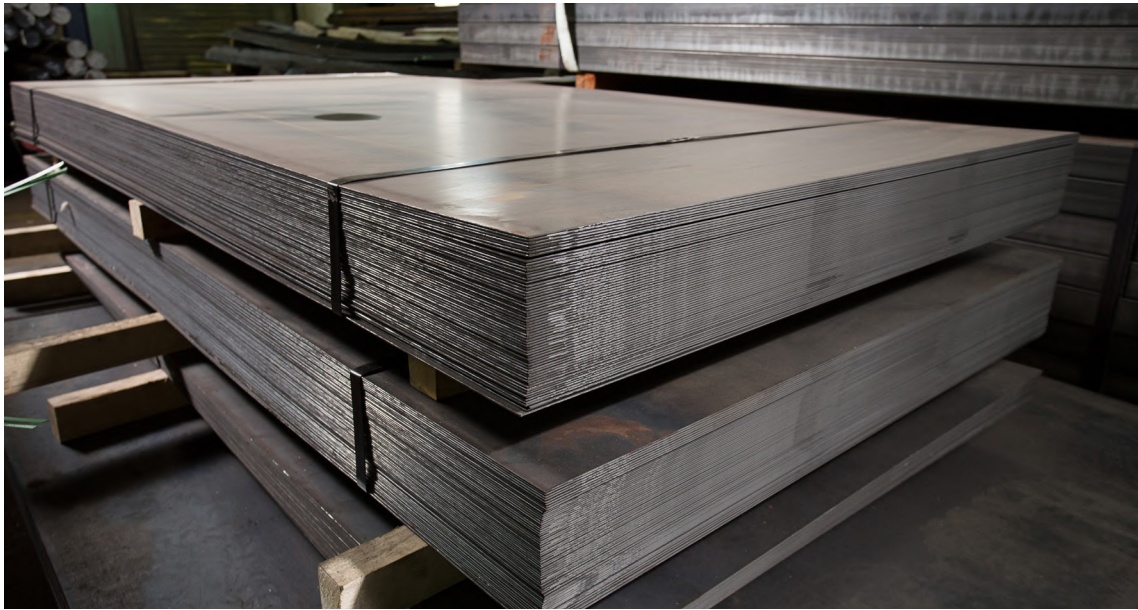

### Specifications: Heavy Plates (Quarto Plates)

| Grade  | Size Range  | Delivery Condition            |
|--|---|-------------------------------|
| <b>High Strength &amp; Ultra High Strength:</b><br><br>AH420, AH460, AH500, AH550, AH620, AH690,<br><br>DH420, DH460, DH500, DH550, DH620, DH690,<br><br>EH420, EH460, EH500, EH550, EH620, EH690,<br><br>FH420, FH460, FH500, FH550 | 6mm – 350mm (T) x<br>900mm – 4800mm (W) x<br>3000mm – 25000mm (L) | <b>TMCP / TMCP + Tempered</b> |

## Shipbuilding Structural Sections

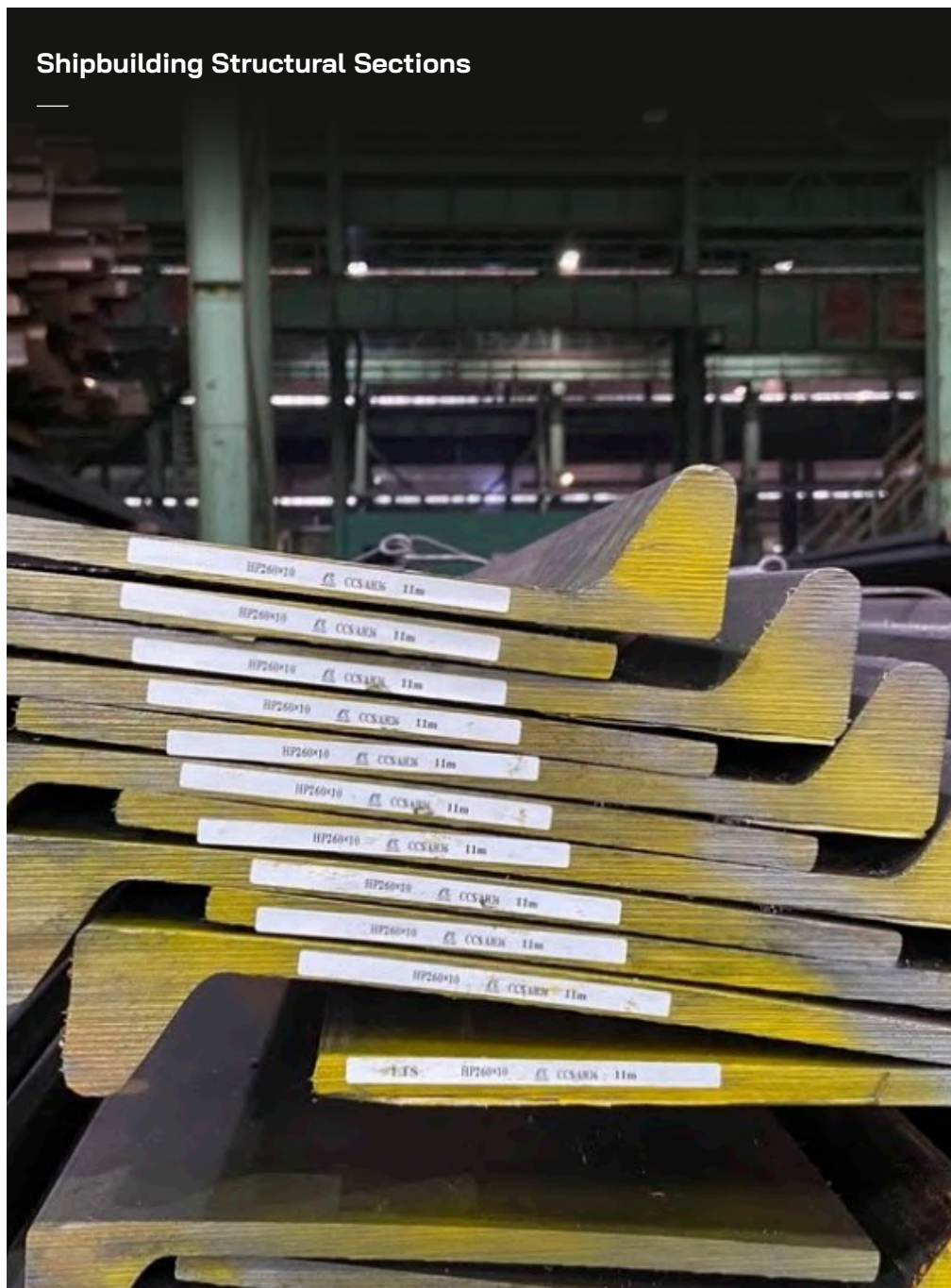

## Bulb Flats

| CATEGORY                        | DETAILS  |
|---------------------------------|--|
| <b>Origins</b>                  | Vietnam, Europe, Asia, America, Middle East, Africa  |
| <b>Applications</b>             | Used as stiffeners for ship hulls, bulkheads, and deck plating.  |
| <b>Technical Properties</b>     | <ul style="list-style-type: none"> <li>The distinctive rounded profile increases the moment of inertia, providing superior bending resistance compared to conventional angle bars of the same weight.</li> <li>The smooth surface with no blind spots or sharp corners ensures easy application of anti-corrosion coatings and simplifies maintenance/cleaning.</li> </ul> |
| <b>Classification Standards</b> | CCS, ABS, NK, BV, LR, RINA, DNV, KR, RS, VR  |

### Product Specifications:

| Designation (HP) | Height (b) (mm) | Web Thickness (t) (mm) | Flange Width (c) (mm) | Weight (kg/m) |
|------------------|-----------------|------------------------|-----------------------|---------------|
| HP 120 x 6       | 120             | 6                      | 17                    | 7.32          |
| HP 140 x 7       | 140             | 7                      | 19                    | 9.75          |
| HP 160 x 8       | 160             | 8                      | 22                    | 12.72         |
| HP 180 x 9       | 180             | 9                      | 25                    | 16.22         |
| HP 200 x 10      | 200             | 10                     | 28                    | 20.14         |
| HP 240 x 12      | 240             | 12                     | 34                    | 29.27         |
| HP 300 x 12      | 300             | 12                     | 43                    | 36.60         |

## Unequal Angle Steel

Featuring an L-shaped cross-section with legs of differing lengths, Unequal Angle Steel is engineered for asymmetrical structural components and specialized technical applications within the shipbuilding and maritime industries.

Stavian Industrial Metal supplies Unequal Angle Steel complete with a full suite of classification society certificates (Class Certificates) adhering to both domestic and international standards. This ensures uncompromising quality for even the most demanding industrial and offshore projects.

---

| CATEGORY                        | DETAILS  |
|---------------------------------|--|
| <b>Origins</b>                  | Vietnam, Europe, Asia, America, Middle East, Africa  |
| <b>Applications</b>             | Specially designed for the fabrication of main frames for mega-vessels and offshore oil & gas structures.  |
| <b>Technical Properties</b>     | <ul style="list-style-type: none"><li>• Specifically engineered to meet diverse thickness and leg length requirements, enabling optimal stress distribution within confined spaces.</li><li>• Enhances the load-bearing capacity for critical blocks/segments while maintaining high assembly flexibility.</li></ul> |
| <b>Classification Standards</b> | CCS, ABS, NK, BV, LR, RINA, DNV, KR, RS, VR  |

---

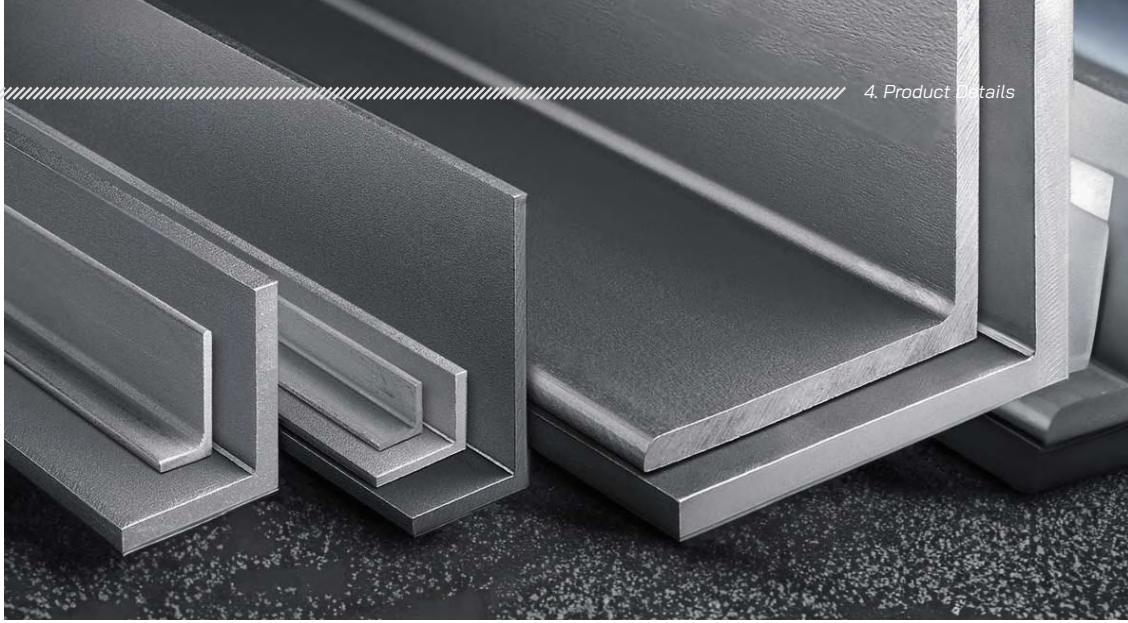

### Product Specifications:

| Dimensions<br>(H x B)<br>(mm) | Web<br>Thickness<br>(t1) (mm) | Flange/Bulb<br>Thickness<br>(t2) (mm) | Weight<br>(kg/m) | Common<br>Applications               |
|-------------------------------|-------------------------------|---------------------------------------|------------------|--------------------------------------|
| 200 x 90                      | 9                             | 14                                    | 23.3             | Small ship framing                   |
| 250 x 90                      | 10                            | 15                                    | 29.4             | Cargo ship framing                   |
| 300 x 90                      | 11                            | 16                                    | 36.3             | Medium-sized<br>container ships      |
| 350 x 100                     | 12                            | 17                                    | 45.3             | Offshore rig structures              |
| 400 x 100                     | 13                            | 18                                    | 53.8             | Ultra Large Crude<br>Carriers (VLCC) |
| 450 x 125                     | 12.5                          | 18                                    | 60.8             | Major offshore<br>projects           |

## Equal Angle Steel

Equal Angle Steel supplied by Stavian Industrial Metal features a stable supply chain and reliable quality, with rigorous control over geometric tolerances to ensure high precision during fabrication.

As a result, our products efficiently meet the demanding requirements for cutting, assembly, and welding at shipyards. This contributes to optimized production schedules, enhanced structural integrity, and guaranteed consistency across all components within the shipbuilding and maritime industries.

| CATEGORY                        | DETAILS  |
|---------------------------------|--|
| <b>Origins</b>                  | Vietnam, Europe, Asia, America, Middle East, Africa  |
| <b>Applications</b>             | <ul style="list-style-type: none"> <li>• Fabrication of support frames, engine beds, ladder systems, handrails, and technical structures within engine rooms.</li> <li>• High versatility with easy installation and replacement, effectively reducing project lead times.</li> </ul>  |
| <b>Technical Properties</b>     | <ul style="list-style-type: none"> <li>• L-shaped cross-section with two perpendicular legs of equal width.</li> <li>• The symmetrical profile ensures high load-bearing capacity, providing excellent resistance to tension, compression, and superior structural rigidity.</li> <li>• Hot-rolled product with high deformation resistance and durability against harsh environmental impacts.</li> </ul> |
| <b>Classification Standards</b> | CCS, ABS, NK, BV, LR, RINA, DNV, KR, RS, VR  |

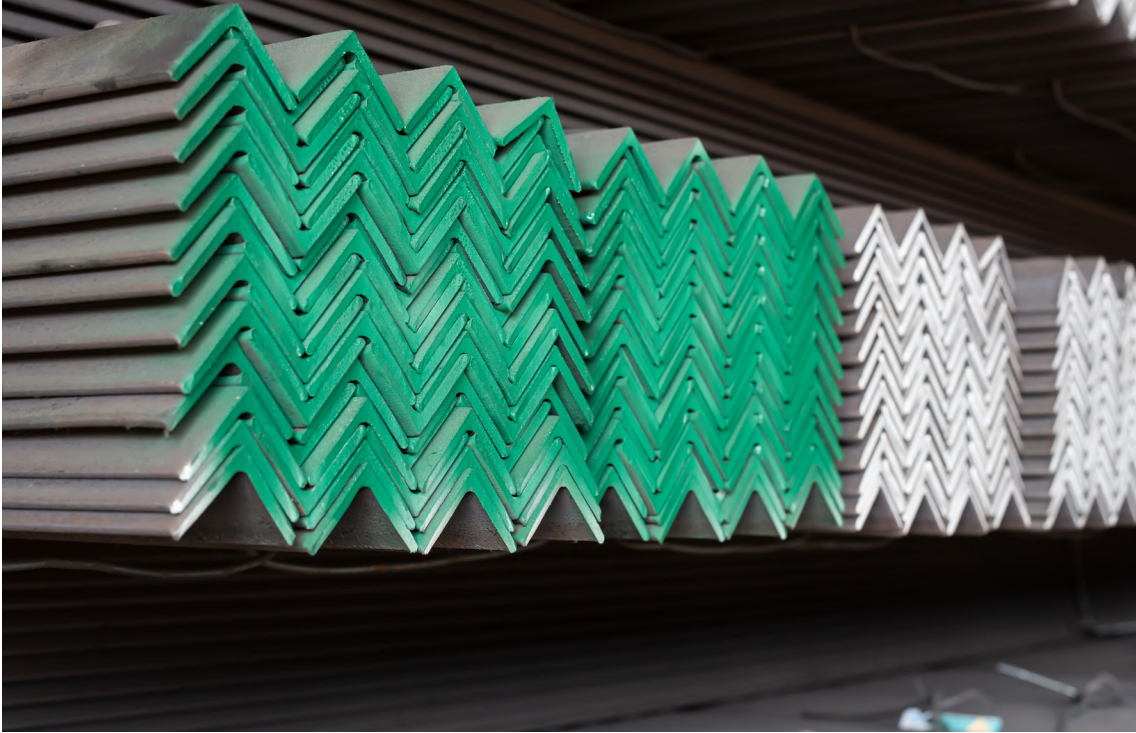

### Product Specifications:

| Section Type | Dimensions<br>(A x B x t) (mm) | Weight<br>(kg/m) | Applications                        |
|--------------|--------------------------------|------------------|-------------------------------------|
| Equal Angle  | 65 x 65 x 6                    | 5.91             | Used for engine beds and handrails. |
| Equal Angle  | 100 x 100 x 10                 | 14.9             | Load-bearing auxiliary structures.  |
| Equal Angle  | 150 x 150 x 12                 | 27.3             | Deck reinforcement and stiffening.  |

The image features a dark teal background with an aerial view of a container ship on the right side. The ship is heavily loaded with multi-colored shipping containers (blue, green, and yellow) stacked on its deck. On the left side, there is a white geometric pattern consisting of several overlapping diamond shapes. The text '5. QUALITY ASSURANCE' is centered in the middle of the image in a white, bold, sans-serif font.

## 5. QUALITY ASSURANCE



## Quality Assurance

Stavian Industrial Metal is committed to supplying shipbuilding steel products that strictly meet quality requirements, technical standards, and classification regulations in the maritime and shipbuilding industry. This serves as a critical foundation to ensure safety, structural durability, and operational efficiency for newbuilding, ship repair, and offshore projects.

Products supplied by Stavian Industrial Metal are capable of meeting certification requirements from reputable domestic and international classification societies, including VR, ABS, DNV, LR, BV, NK, KR, CCS, and RINA. Each shipment is subject to stringent control in terms of origin, specifications, and quality, and is accompanied by complete CO/CQ documentation and relevant technical certificates. In addition, inspections and verification are conducted at the manufacturing plant in accordance with project requirements prior to delivery. This process enables customers to maintain transparency, consistency, and reliability throughout the entire shipbuilding material supply chain.

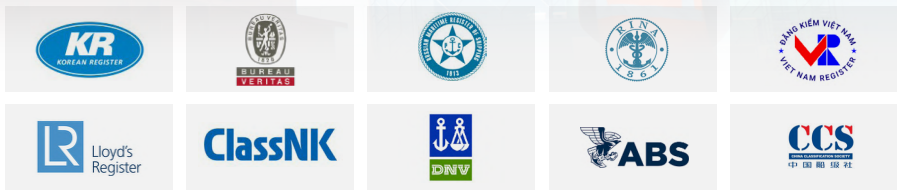

Beyond compliance with standards, Stavian Industrial Metal has progressively strengthened its market position through strategic cooperation with reputable fabrication and shipbuilding companies such as Viet Hai, An Dong, and Dai Dung. Practical collaboration with these industry partners demonstrates the company's supply capability, technical coordination, and responsiveness to the specific requirements of the maritime sector.

Building on this foundation, Stavian Industrial Metal continues to expand its supply capabilities in line with international standards, aiming to become a trusted partner for large-scale shipbuilding and maritime infrastructure projects in Vietnam, across the region, and globally.

# CONTACT INFORMATION

## BUSINESS NAME

STAVIAN INDUSTRIAL METAL.,JSC

---

## HEADQUARTERS

No. 508 Truong Chinh Street, Kim Lien Ward, Hanoi City

---

## HAI PHONG BRANCH

6th Floor, Thanh Dat 1 Building, No. 3 Le Thanh Tong Street, Ngo Quyen Ward, Hai Phong City

---

## SOUTHERN BRANCH

12Ath Floor, Vincom Center Dong Khoi, 72 Le Thanh Ton Street, Saigon Ward, Ho Chi Minh City

---

## CONTACT

Phone: +84 24 7100 1868

Phone: +84 97 5271 499

Email: [info@stavianmetal.com](mailto:info@stavianmetal.com)

Website: [www.stavianmetal.com](http://www.stavianmetal.com)









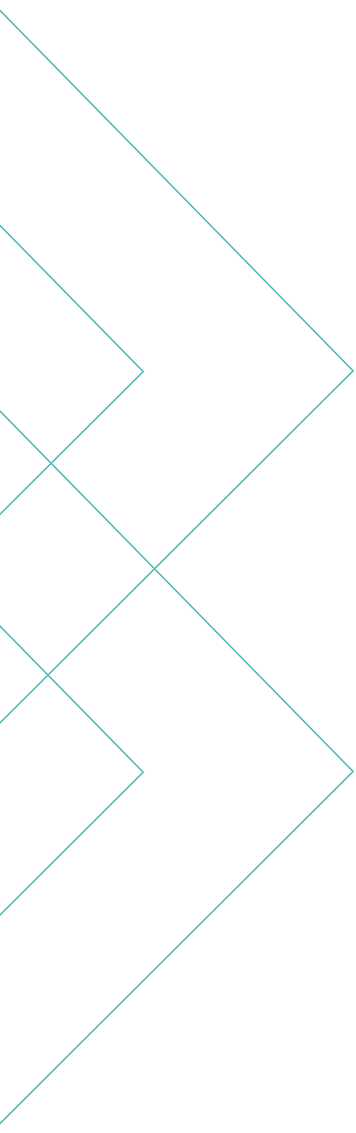

SCAN QR CODE TO  
ACCESS OUR WEBSITE



SCAN QR CODE TO DOWNLOAD  
OUR COMPANY PROFILE